

Type A1-G (1-Bedroom)

Unit: #03-12
Area: 409 sq ft / 38 sq m
(Inclusive of A/C Ledge & PES)

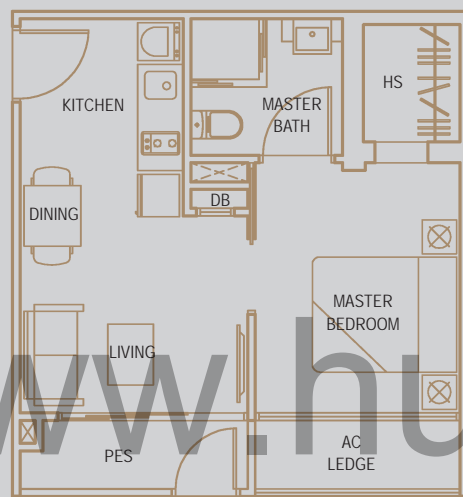

Type A1 (1-Bedroom)

Unit: #04-12 to #08-12
Area: 431 sq ft / 40 sq m
(Inclusive of A/C Ledge & Balcony)

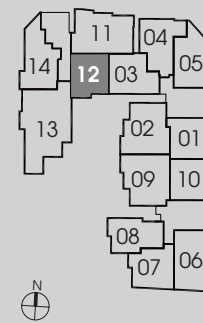
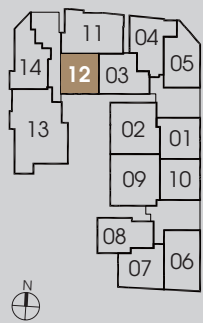
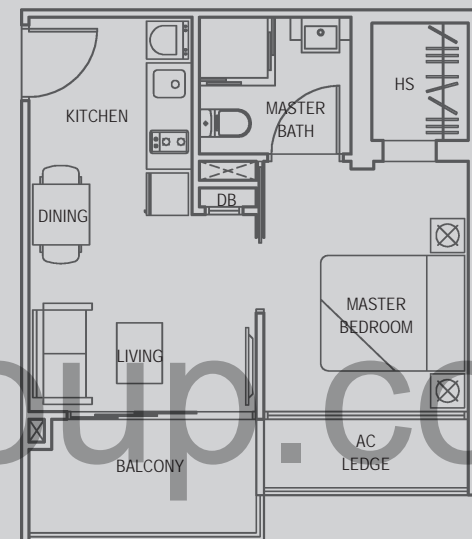

Type A2 (1-Bedroom + Study)

Unit: #03-10 to #08-10

Area: 452 sq ft / 42 sq m

(Inclusive of A/C Ledge & Balcony)

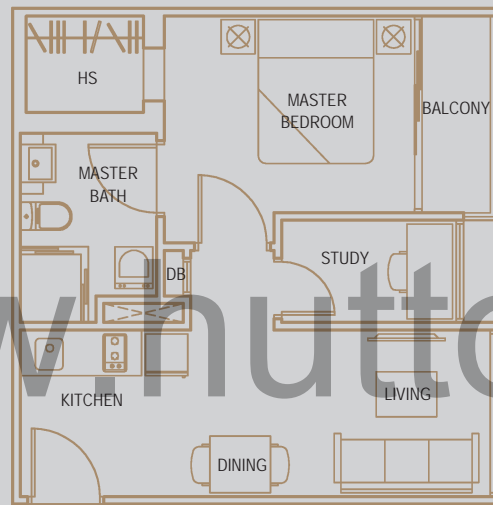

Type A2a (1-Bedroom + Study)

Unit: #03-01 to #08-01

Area: 463 sq ft / 43 sq m

(Inclusive of A/C Ledge & Balcony)

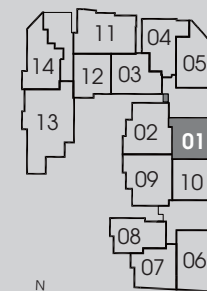
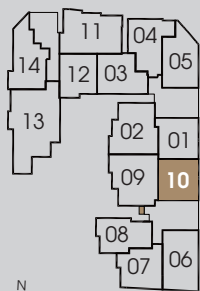
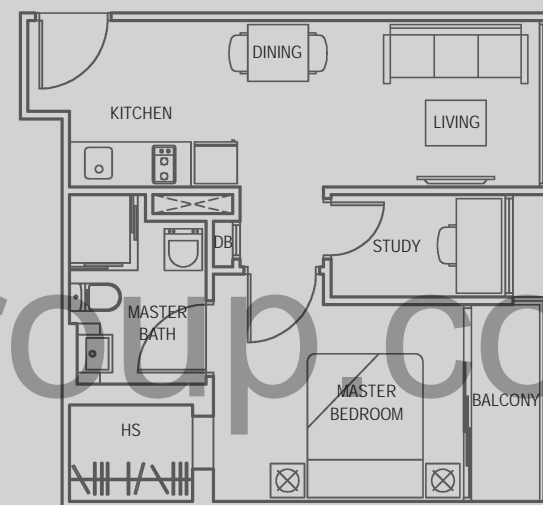

Type A3-G (1-Bedroom)

Unit: #03-07

Area: 463 sq ft / 43 sq m

(Inclusive of A/C Ledge & PES)

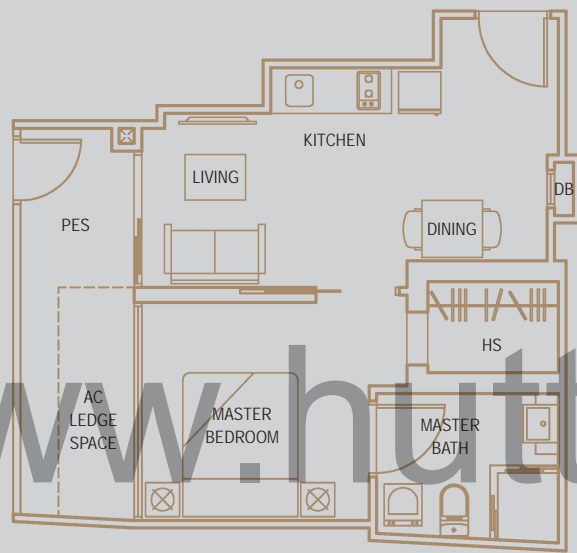

Type A3 (1-Bedroom)

Unit: #04-07 to #08-07

Area: 441 sq ft / 41 sq m

(Inclusive of A/C Ledge & Balcony)

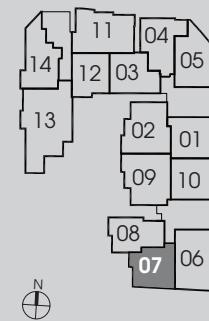
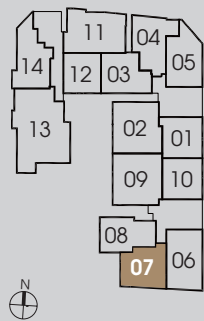
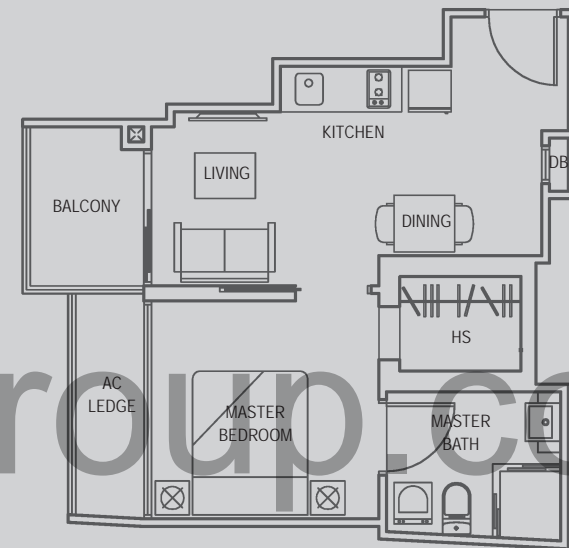

Type A4-G (1-Bedroom)

Unit: #03-08
Area: 474 sq ft / 44 sq m
(Inclusive of A/C Ledge & PES)

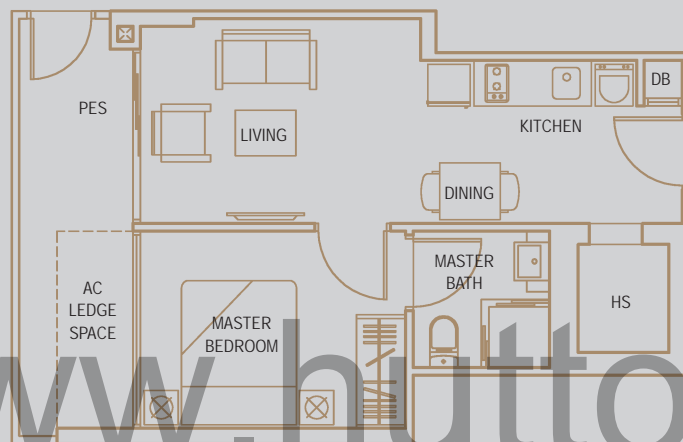

Type A4 (1-Bedroom)

Unit: #04-08 to #08-08
Area: 452 sq ft / 42 sq m
(Inclusive of A/C Ledge & Balcony)

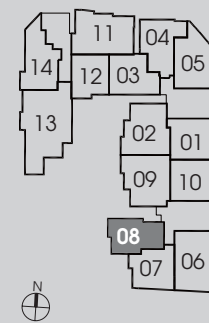
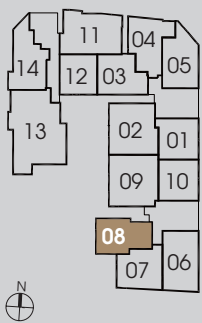
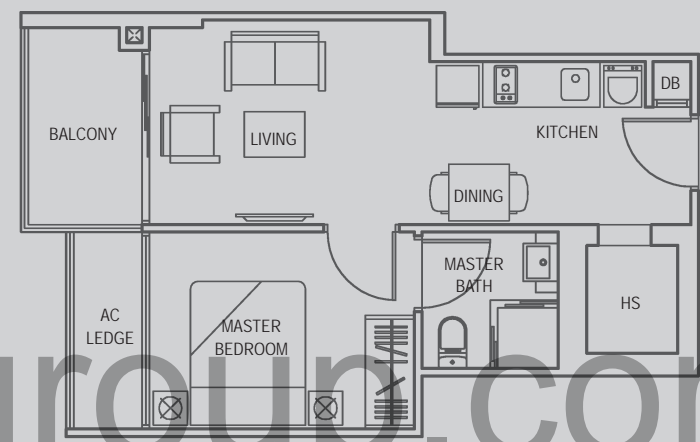

Type B1 (2-Bedroom)

Unit: #03-05 to #08-05
Area: 527 sq ft / 49 sq m
(Inclusive of A/C Ledge & Balcony)

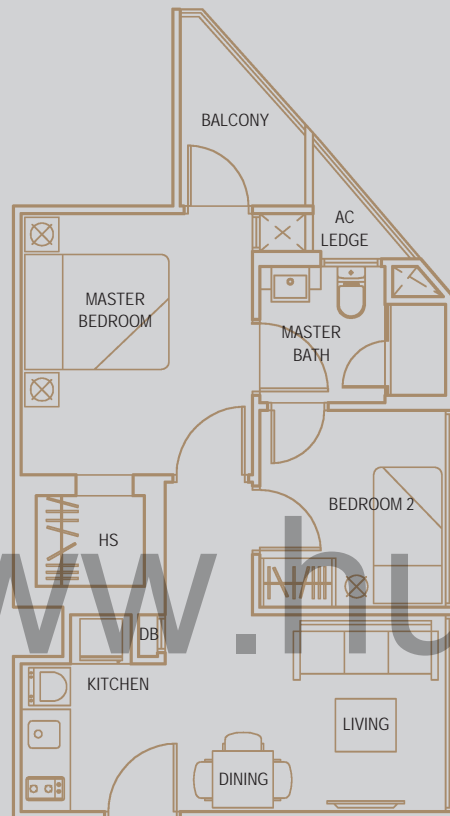

Type B2-G (2-Bedroom)

Unit: #03-04
Area: 538 sq ft / 50 sq m
(Inclusive of A/C Ledge & PES)

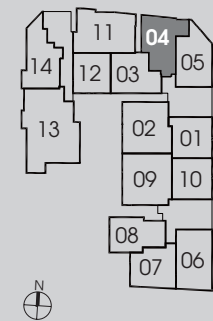
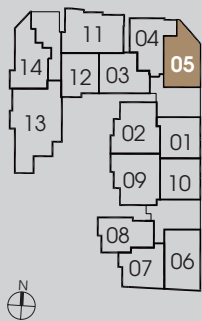
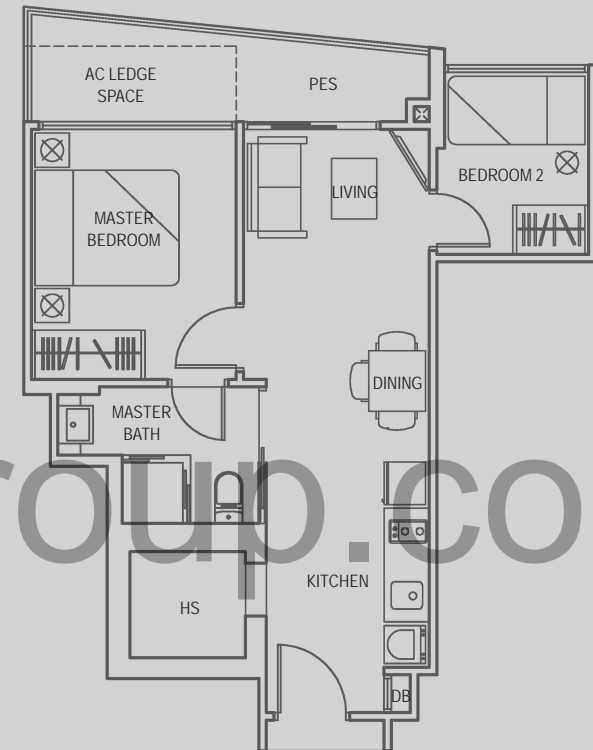

Type B2 (2-Bedroom)

Unit: #04-04 to #08-04
Area: 517 sq ft / 48 sq m
(Inclusive of A/C Ledge & Balcony)

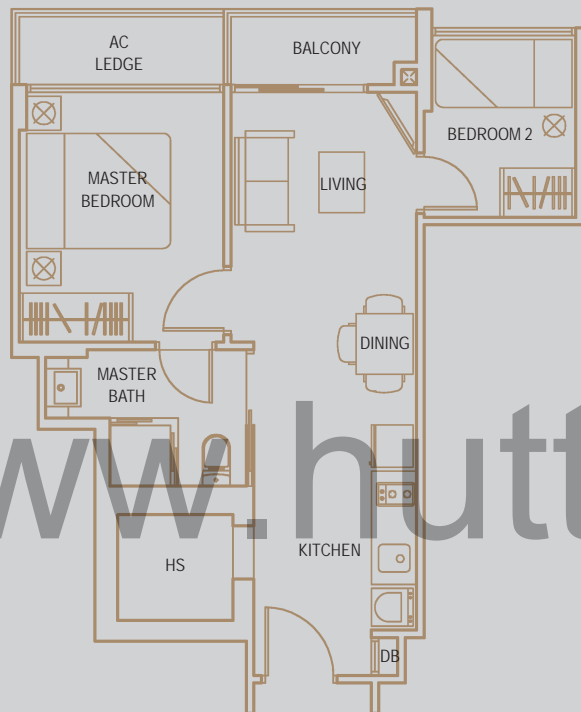

Type B3 (2-Bedroom)

Unit: #03-03 to #08-03
Area: 495 sq ft / 46 sq m
(Inclusive of A/C Ledge)

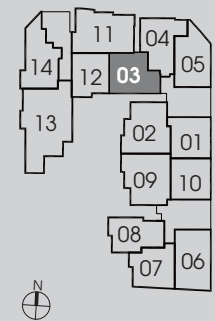
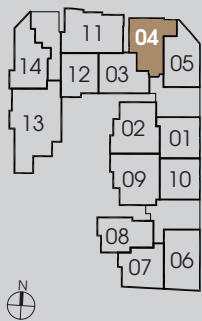
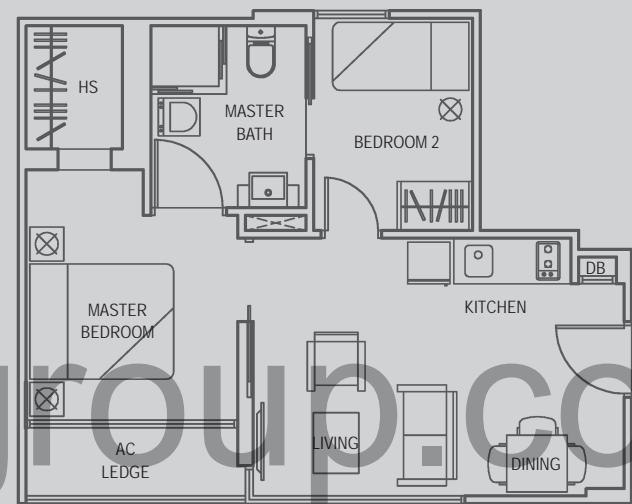

Type B4-G (2-Bedroom)

Unit: #03-02

Area: 667 sq ft / 62 sq m

(Inclusive of A/C Ledge & PES)

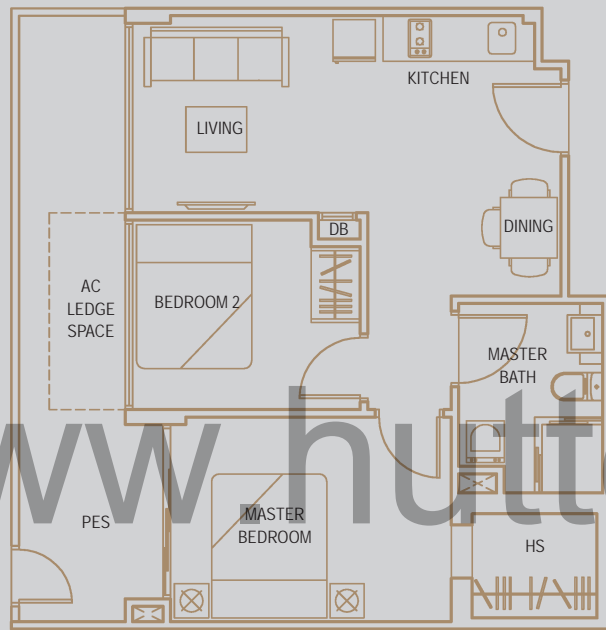

Type B4 (2-Bedroom)

Unit: #04-02 to #08-02

Area: 603 sq ft / 56 sq m

(Inclusive of A/C Ledge & Balcony)

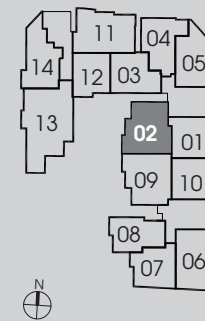
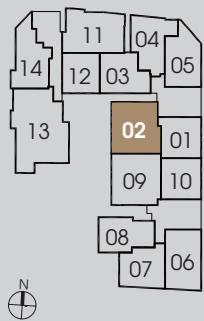
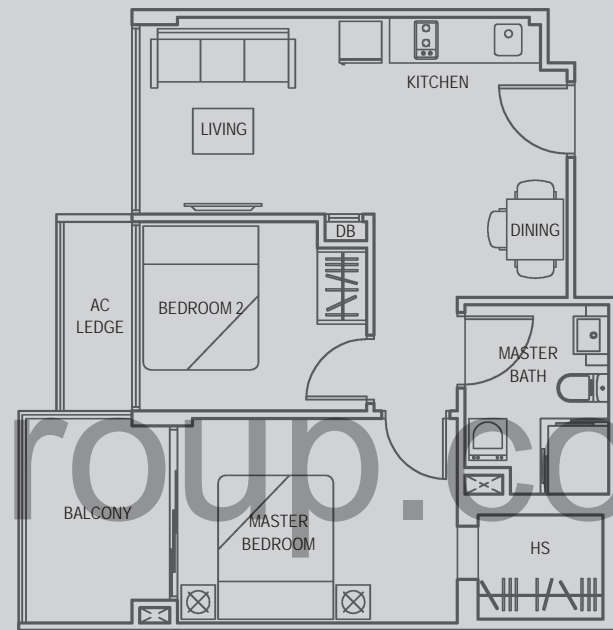

Type B4a-G (2-Bedroom)

Unit: #03-09

Area: 689 sq ft / 64 sq m

(Inclusive of A/C Ledge & PES)

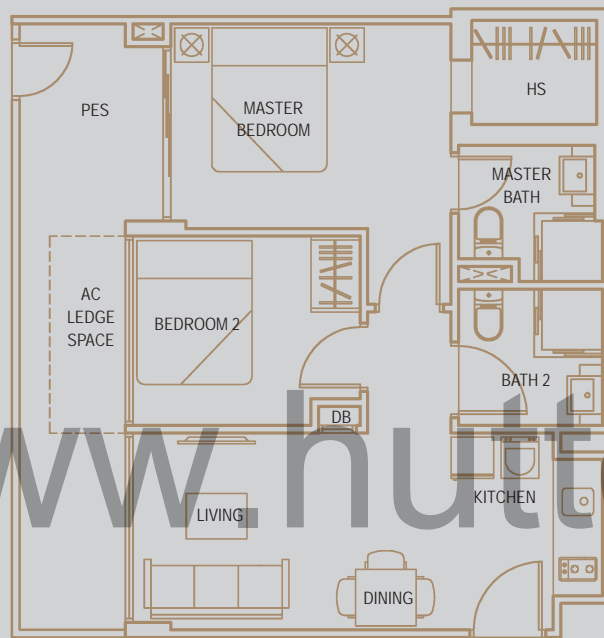

Type B4a (2-Bedroom)

Unit: #04-09 to #08-09

Area: 624 sq ft / 58 sq m

(Inclusive of A/C Ledge & Balcony)

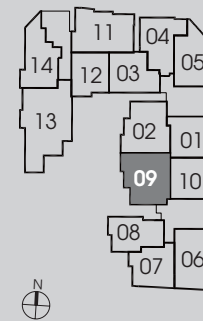
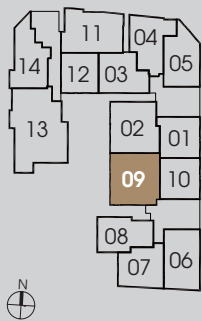
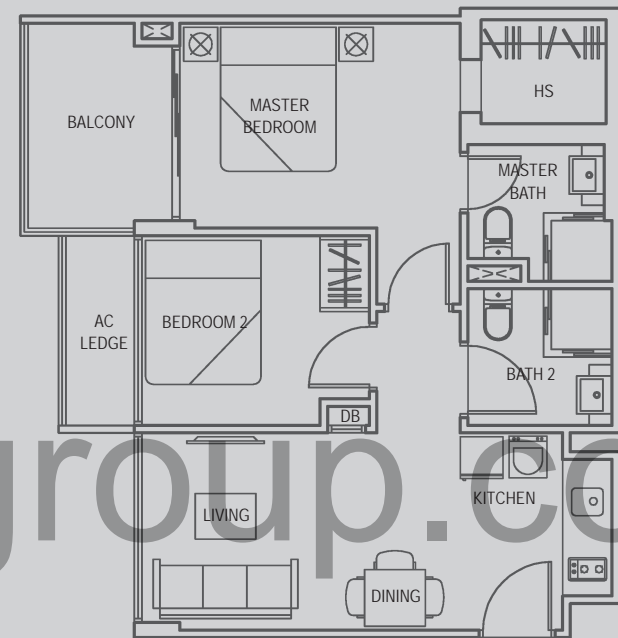

Type B5 (2-Bedroom)

Unit: #03-14 to #08-14
Area: 560 sq ft / 52 sq m
(Inclusive of A/C Ledge & Balcony)

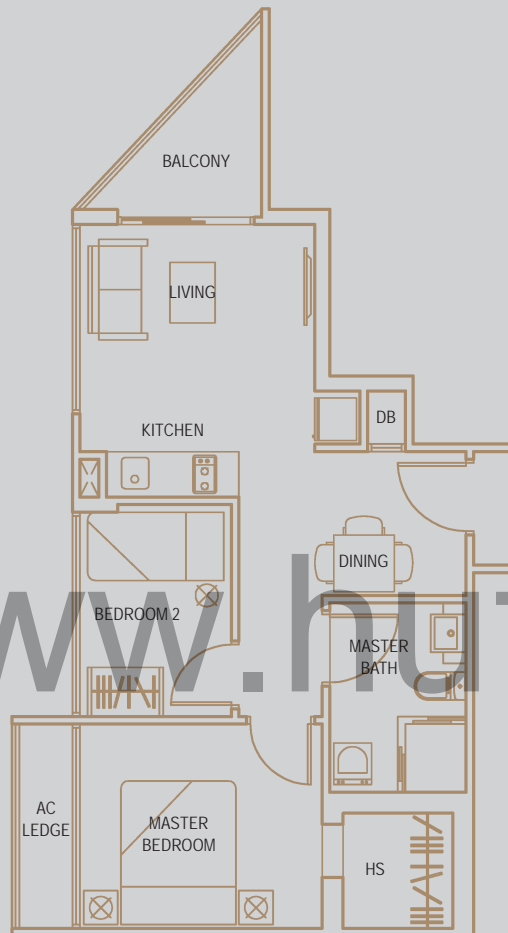

Type B6-G (2-Bedroom)

Unit: #03-11
Area: 667 sq ft / 62 sq m
(Inclusive of A/C Ledge, PES & Balcony)

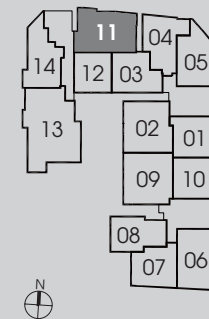
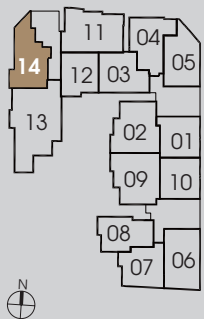
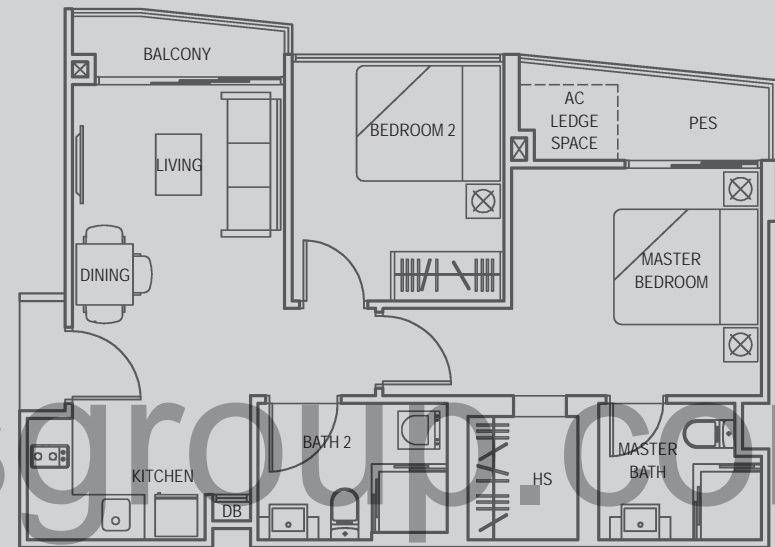

Type B6 (2-Bedroom)

Unit: #04-11 to #08-11
Area: 657 sq ft / 61 sq m
(Inclusive of A/C Ledge & Balcony)

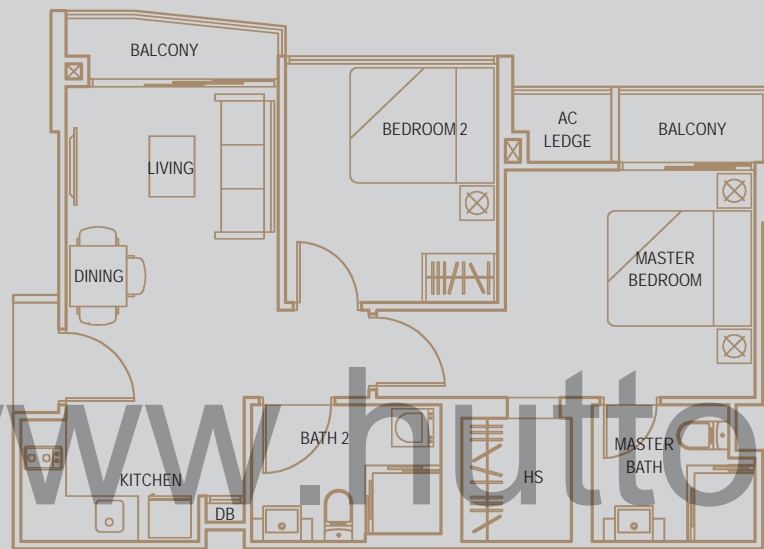

Type C1 (3-Bedroom)

Unit: #03-06 to #08-06
Area: 603 sq ft / 56 sq m
(Inclusive of A/C Ledge)

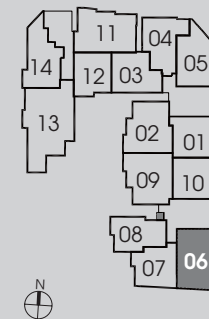
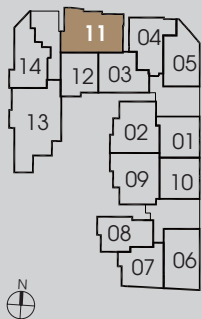
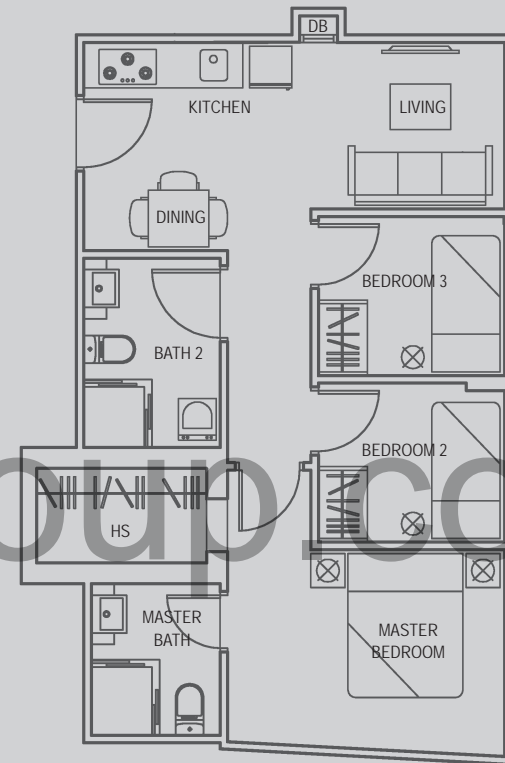

Type C2-G (3-Bedroom)

Unit: #03-13
Area: 1,055 sq ft / 98 sq m
(Inclusive of A/C Ledge & PES)

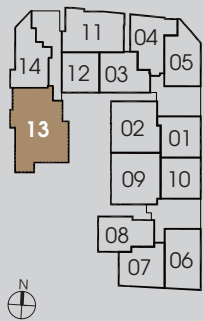
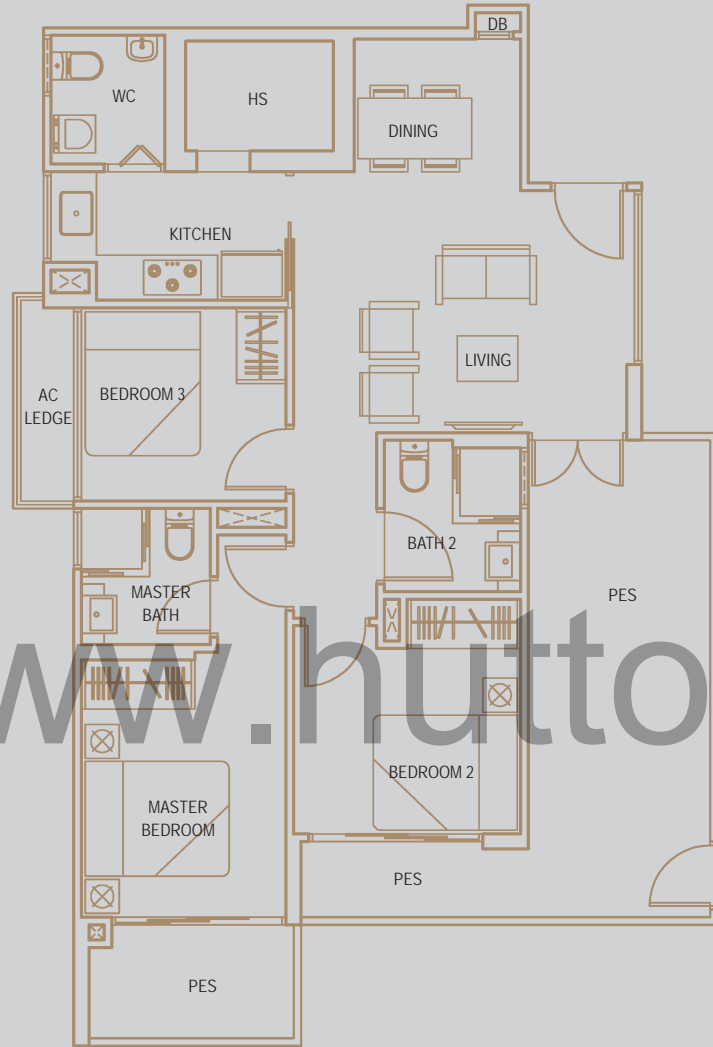

Type C2 (3-Bedroom)

Unit: #04-13 to #08-13
Area: 958 sq ft / 89 sq m
(Inclusive of A/C Ledge & Balcony)

